

WASH BASIN

PRODUCT ID : SX14013

(RB.SBX.01G104.01.11)

Fine fire clay above counter wash basin (vessel basin) with single tap hole in centre. Designed to be installed on a cantilevered wooden base or any chosen surface.



FEATURES

- Fine fire clay wash basin without overflow hole
- Contemporary design
- Single tap hole in centre
- Deep bowl for comfortable use
- Fulfills high design and quality expectations

INCLUDED COMPONENTS

- Faucets not included

COLOUR

- White

WARRANTY

- 5 year written warranty against crazing and dunting

STANDARDS APPLICABLE

Specified model meets or exceeds the following:

- BS EN 14688 : 2006

TECHNICAL INFORMATION

** Approximate measurements for comparison only

CONFIGURATION	COUNTER TOP WASH BASIN
Weight	20 kg
Basin Area	510 X 300 X 110 mm
Height - Floor to Rim	850 mm
Nominal Dimensions	730 X 450 X 160 mm
Faucet Hole	35 mm
Waste Hole	45 mm
Water Depth	110 mm

TECHNICAL DRAWINGS

All drawings contain the necessary measurements, which are subject to standard tolerances. They are stated in mm, are drawn on a scale of 1:20 and are non-binding. Exact measurements, in particular for customized installation scenarios, can only be taken from the finished ceramic piece.

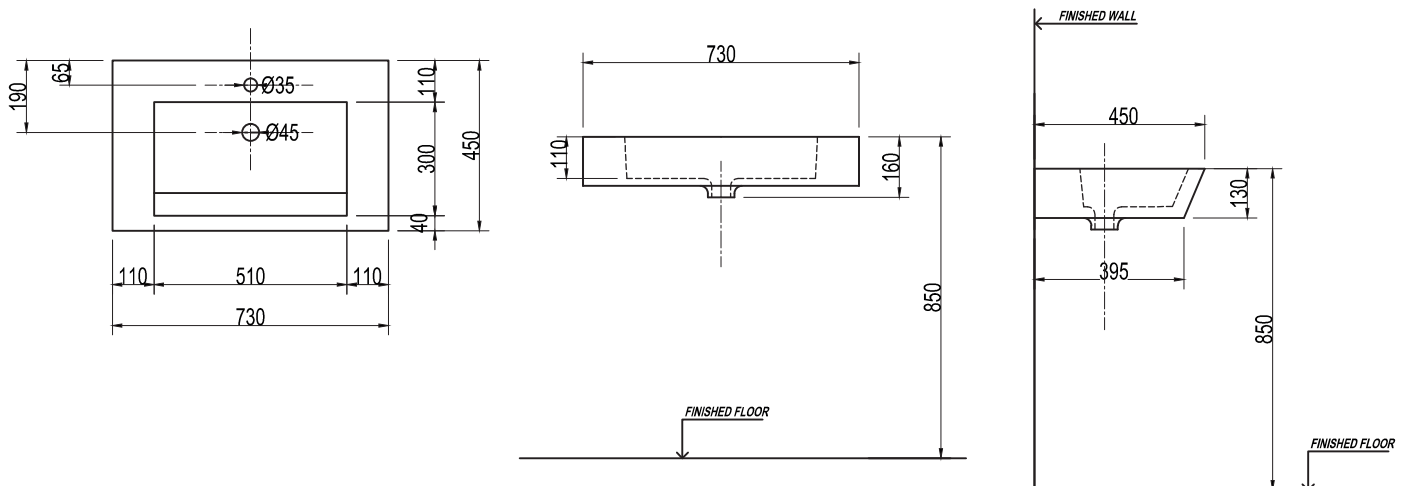

INSTALLATION NOTES

- Install this product according to the installation guide



Rocell Bathware Limited.
 No. 10, R. A. De Mel Mawatha, Colombo 03, Sri Lanka.
 T: +94 11 4 799 400 F: +94 11 4 720 077 E: info@rcl.lk W: www.rocellbathware.com